

BK 121 Pg 69

LEGEND:  
NCGS-NORTH CAROLINA GEODETIC MONUMENT  
EIS-EXISTING IRON STAKE  
EIP-EXISTING IRON PIPE  
EIR-EXISTING IRON ROD  
ERB-EXISTING REBAR  
SIR-SET IRON ROD  
ECM-EXISTING CONCRETE MONUMENT  
PK-PK MASONRY NAIL  
CP-COMPUTED POINT  
N/F-NOW OR FORMERLY  
R/W-RIGHT OF WAY  
--- PROPERTY LINE  
--- ADJACENT PROPERTY LINE  
--- RIGHT-OF-WAY  
--- SANITARY SEWER  
--- FENCELINE

AREA: (BY COORDINATE COMPUTATION)  
TRACT 1 35.86 ACRES  
TRACT 2 4.89± ACRES  
TOTAL 40.75 ACRES

SUBJECT PROPERTY INFORMATION  
PIN # 0540-24-3601  
PIN # 0540-34-2109  
DB: 3091, PG. 057

NOTES:  
1) ALL DISTANCES SHOWN ARE HORIZONTAL GROUND DISTANCES.  
2) NONCONFORMING STRUCTURES HAVE NOT BEEN CREATED BY THIS SURVEY.  
3) THIS SURVEY IS OF AN EXISTING PARCEL OR PARCELS OF LAND AND DOES NOT CREATE A NEW STREET OR CHANGE AN EXISTING STREET.  
4) A PORTION OF THIS PROPERTY IS LOCATED WITHIN THE 100 YEAR FLOOD PLAIN AS SHOWN ON FEMA- FIRM PANEL 370076-00858 DATED FEBRUARY 17, 1982. NOT SHOWN GRAPHICALLY ON THIS MAP.

STATE OF NORTH CAROLINA  
COUNTY OF CUMBERLAND

I, Annie F. Feltch, REVIEW OFFICER  
OF CUMBERLAND COUNTY, CERTIFY THAT THE MAP  
OR PLAT TO WHICH THIS CERTIFICATE IS AFFIXED  
MEETS ALL STATUTORY REQUIREMENTS FOR  
RECORDING.

Annie F. Feltch  
REVIEW OFFICER

DATE: 11-13-07

I, DAVID R. BECKWITH, CERTIFY THAT THIS PLAT WAS DRAWN  
UNDER MY SUPERVISION FROM AN ACTUAL SURVEY MADE  
UNDER MY SUPERVISION (DEED DESCRIPTION RECORDED IN  
BOOK 121, PAGE 69, ETC.) (OTHER); THAT THE BOUNDARIES  
NOT SURVEYED ARE CLEARLY INDICATED AS DRAWN FROM  
INFORMATION FOUND IN BOOK 121, PAGE 69, THAT THE  
RATIO OF PRECISION IS 1:10,000; THAT THIS PLAT WAS  
PREPARED IN ACCORDANCE WITH G.S. 47-30 AS AMENDED;  
WITNESS MY ORIGINAL SIGNATURE, LICENSE NUMBER 1765,  
SEAL THIS 11 DAY OF NOV, A.D. 2007.

David R. Beckwith  
PROFESSIONAL LAND SURVEYOR - L-3889  
NORTH CAROLINA  
LAND SURVEYOR  
DAVID R. BECKWITH

NCGS "HIS"(GRID)  
N: 506,314.0989  
E: 2,037,814.4080

NCGS "COLLEGE"(GRID)  
N: 503,380.0463  
E: 2,036,772.0290

NAME OF STREAM	LINEAR FEET OF PROTECTED STREAM	BUFFER ONE SIDE OF BOTH SIDES OF STREAM	LINEAR FEET OF BUFFER PROTECTED
CAPE FEAR RIVER	1785	1785	1785
PRIMARY TRIBUTARY	244	244	488
SECONDARY TRIBUTARY	1137	1137	2274

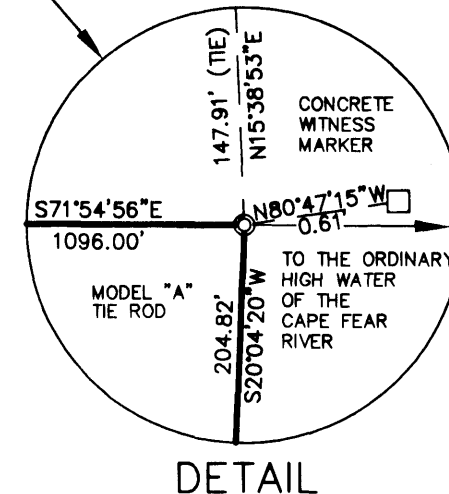
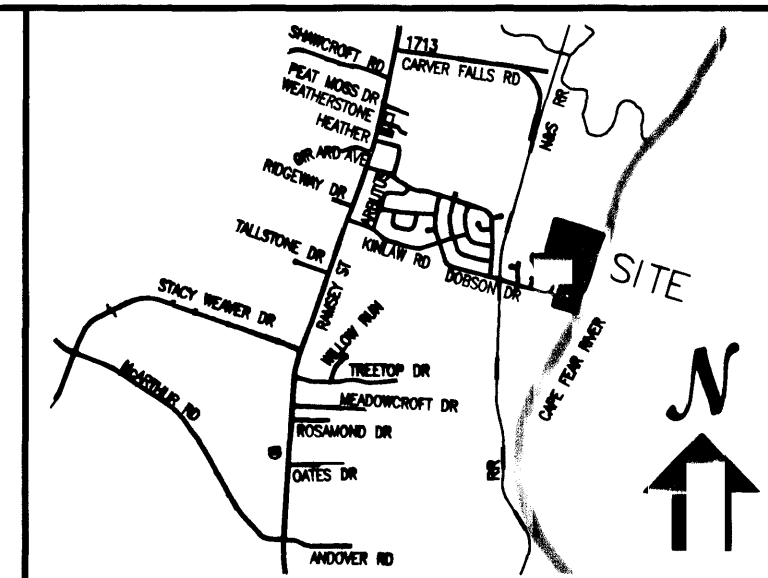

DETAIL

ORDINARY HIGH WATER  
MARK OF THE  
CAPE FEAR RIVER

NO APPROVAL REQUIRED  
BY THE CITY OF FAYETTEVILLE

Marsha Bryant  
SIGNATURE DATE

Planner 11-13-07  
TITLE

OFFICE OF FAYETTEVILLE  
INSPECTION DEPARTMENT  
SECTION  
Certificate of Approval for Recording  
Witnessed Provision  
I certify that the plat shown hereon complies with the Watermark  
Inspection Ordinance and is approved by the Public Works  
Commission for recording in the Register of Deeds office  
Frank J. Jumper  
Inspector Director  
11/17/07  
Date  
NOTICE:  
This plat is within a water supply watershed and  
development restrictions may apply.

GRAPHIC SCALE

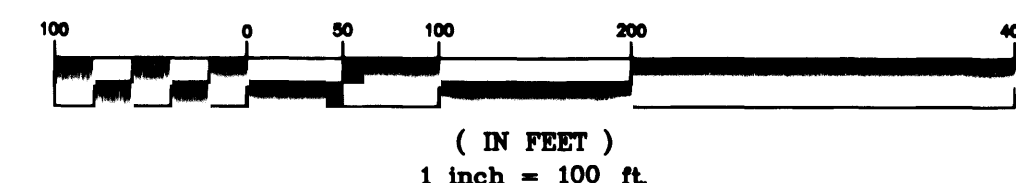

**MCKIM & CREED**  
104 GILLESPIE STREET  
FAYETTEVILLE, NORTH CAROLINA 28301  
PH.(910) 323-3400  
FAX(910) 323-5232

Internet Site: <http://www.mckimcreed.com>

BOUNDARY SURVEY  
OF THE  
KINLAW TRACT  
FOR  
CONSERVATION EASEMENT FOR THE STATE OF NORTH CAROLINA  
CLEAN WATER MANAGEMENT TRUST FUND AND  
SANDHILLS AREA LAND TRUST CWMTF GRANT # 2005B-042  
DATE: JULY 20, 2006  
CUMBERLAND COUNTY  
FAYETTEVILLE  
SCALE: 1" = 100'  
NORTH CAROLINA

PROJECT #: 032580004  
PROJ. SVYR: DRB  
DRAWN BY: CLM  
SHEET #: 1 OF 1