

Harold Kelly
NC Licensed Soil Scientist, REHS, CPSS
412 Clayton Ave.
Roxboro, NC 27573
(336) 322-4724 (office)
(336) 598-2382 (cell)

December 2, 2023

Evan Wells
206 College St. #1143
Pineville, NC 28134
evan@eawland.com

RE: Preliminary soil evaluation / Parcel ID: 9832193351(34.5 acres)/ Mt. Willing Road/ Orange County, NC

Dear Mr. Wells:

At your request a preliminary soil evaluation was conducted on the parcel referenced above. A preliminary soil evaluation is conducted by making a series of soil auger borings at intervals across the property. Each soil boring was classified in accordance with State rules and regulations governing the permitting and installation of septic systems.

Unfortunately, the entire parcel would be classified as '**Unsuitable**' and would not support the installation of Conventional or Accepted septic systems. These are the types of systems predominately installed across North Carolina. However, there is a portion of the parcel that has useable soil depths of 14" to 20" (to unsuitable soil characteristics; soil wetness or expansive mineralogy) and would potentially support the permitting of Innovative aerobic subsurface drip systems. The attached soil map shows the estimated area that appears to meet the minimum requirements for the permitting and installation of drip systems. The area would be large enough to support systems for multiple homes.

Aerobic subsurface drip systems are designed to distribute pretreated wastewater to a series of drip lines buried 6 to 12" below the ground surface. A typical drip system requires a drain field area of approximately 8,000 ft² (system/repair). These systems are usually designed by an engineering firm who will conduct a detailed soil investigation including measurements of soil hydraulic conductivity. They will then provide a system design, including method of pretreatment, and certify the system once installed.

The costs for a system design, permitting, and installation varies, but usually exceeds \$40,000. In addition, these systems must be maintained and inspected several times a year to ensure that the system is operating properly. The owner of the system is required to contract with a Certified Operator to provide that service at an additional cost.

In summary, due to shallow soil depths to soil wetness and/or expansive mineralogy, the entire parcel would be classified as **unsuitable** for conventional or accepted septic systems. However, there is a large area along the northern portion of the parcel that appears to meet the minimum requirements for the installation of aerobic drip systems.

This report and the enclosed soil map are based on my observations and opinion as a licensed soil scientist. Permitting authority for septic systems is delegated to the Orange County Health Department. A detailed soil/site evaluation and system designs would be required prior to issuance of the required septic permits. Please let me know if you have any questions (336-598-2382).

Sincerely,



Harold Kelly
NC Licensed Soil Scientist

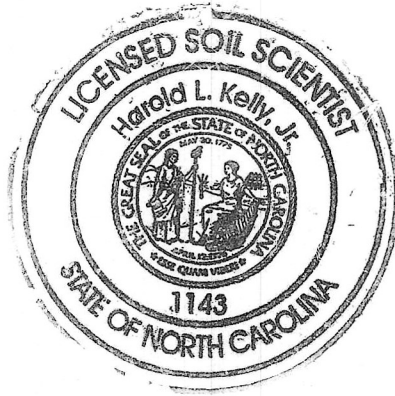

Orange County

Harold Kelly
 Licensed Soil Scientist
 412 Clayton Ave.
 Roxboro, NC 27573
 (336) 322-4724 office
 (336) 598-2382 cell
 hkelly0501@gmail.com

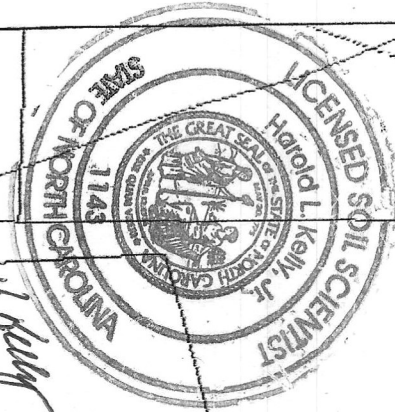

H Kelly
12/2/23

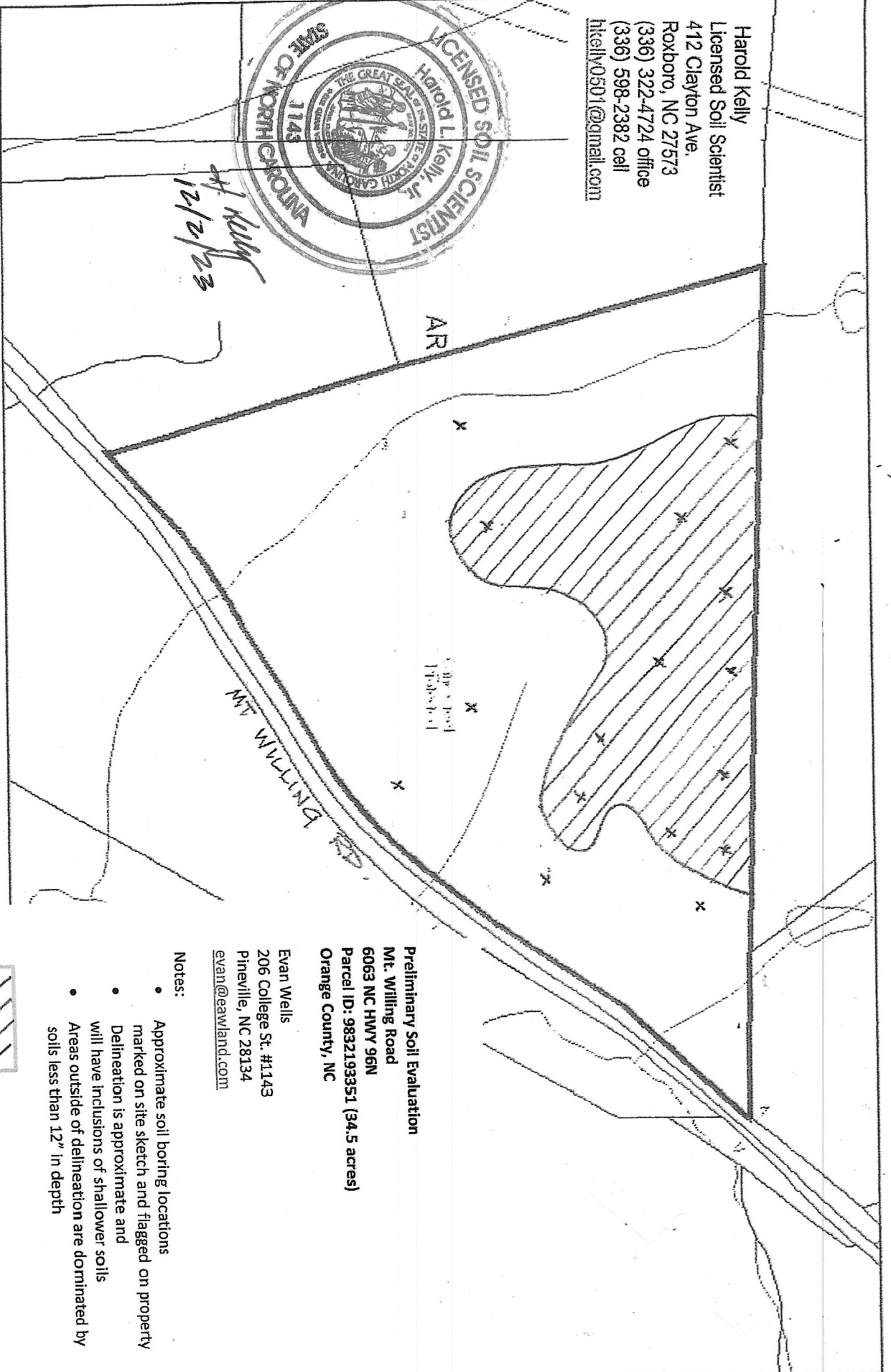

PIN: 9832193351
 Owner 1: TRUSTED TRACTS LLC
 Owner 2:
 Size: 34.55 A
 Legal Desc: 2 ALEXANDER DAWSON P116/19

Zonhg:	AR
ECOD:	NO
MTGZ:	NO
SCOD:	NO
EIO:	NO
EVO:	NO

Preliminary Soil Evaluation
 Mt. Willing Road
 6063 NC HWY 96N
 Parcel ID: 9832193351 (34.5 acres)
 Orange County, NC

Evan Wells
 206 College St. #1143
 Pineville, NC 28134
 evan@eawland.com

- Notes:**
- Approximate soil boring locations marked on site sketch and flagged on property
 - Delineation is approximate and will have inclusions of shallower soils
 - Areas outside of delineation are dominated by soils less than 12" in depth



Soils 14" to 20" in depth
 System type: Subsurface aerobic drip (Type Ve)

X = Soil boring locations

Site plan scale: 1" = 300'